



**COMMERCE STREET:
ST. MARY'S TO SANTA ROSA**

MAY 14, 2015

PRESENTED BY:
DAVID MCBETH, P.E., PROJECT MANAGER, TCI



2012-2017 DOWNTOWN PROJECTS

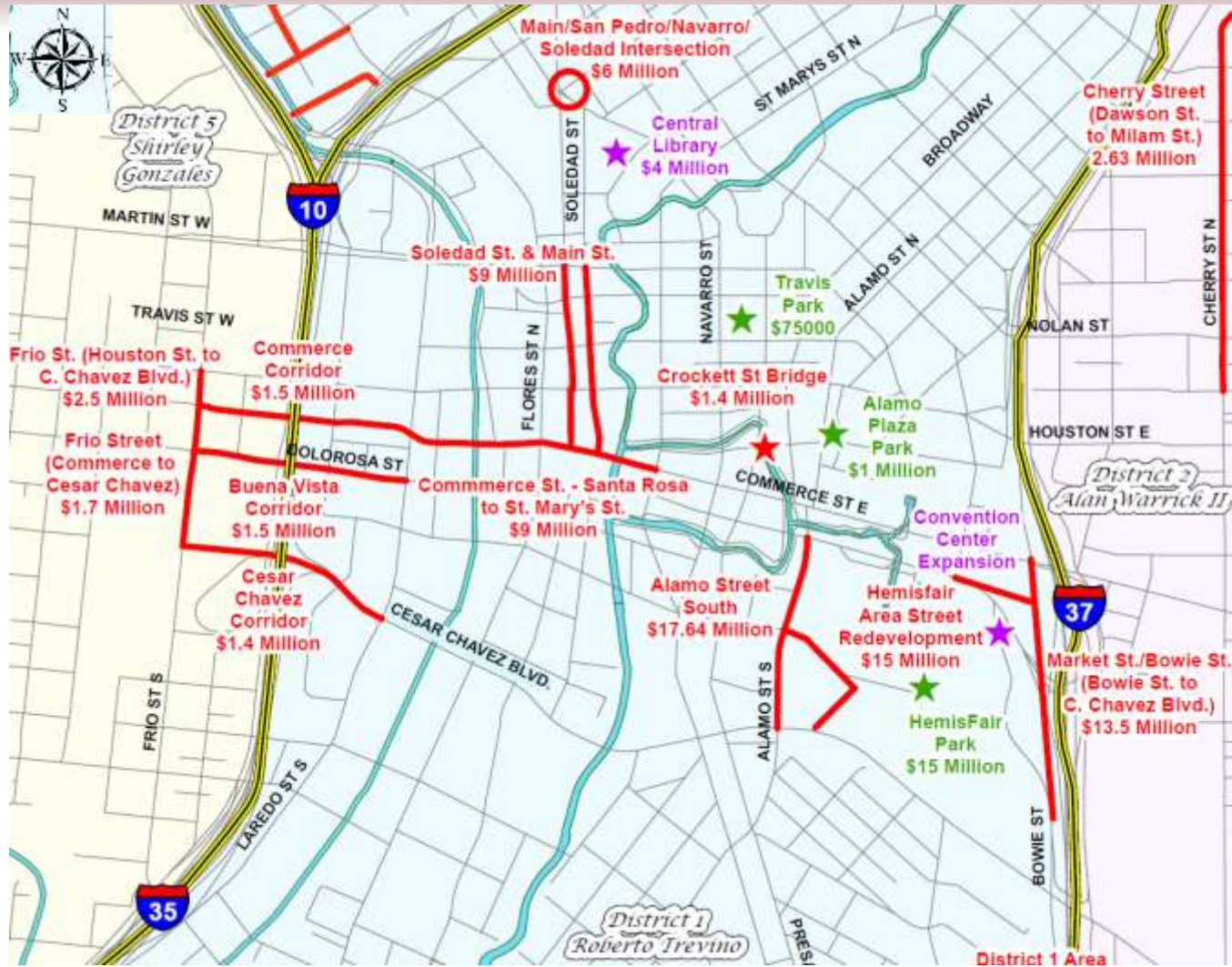



COMMERCE ST. PROJECT LIMITS

Santa Rosa

St. Mary's St.



Commerce St.



PROJECTED SCOPE OF WORK

- Widening of sidewalk along the north side of Commerce St. between Santa Rosa and St. Mary's streets.
- The Bus-Only lane will be removed to reallocate the sidewalks and the remaining lanes. (Two 10-foot inside lanes and one 12-foot outside lane to accommodate the VIA Primo Bus)
- The north side of Commerce St. was initially selected for widened sidewalks to complement the transit service and to provide additional sidewalk space for pedestrians, shelters, and amenities. We are now planning to design for full width reconstruction for the length of the project, and will construct to available funds.
- Sidewalks should be a minimum of 8 to 10 feet wide. Anticipate the sidewalks on the north side to be 8 feet minimum to 18 feet maximum.
- Inset parking would be placed only where an additional 8 feet sidewalk minimum is available.
- Streetscape amenities, lighting and landscaping will be included.



BUDGET AND SCHEDULE

Project Budget:

\$9 Million from 2012-2017 Bond Program

Schedule:

Design Completion: December 2015

Estimated Construction Begin: March 2016

Estimated Construction End: March 2017



EXISTING AND PROPOSED CONDITIONS



Figure 3-5: Photo of Commerce Street

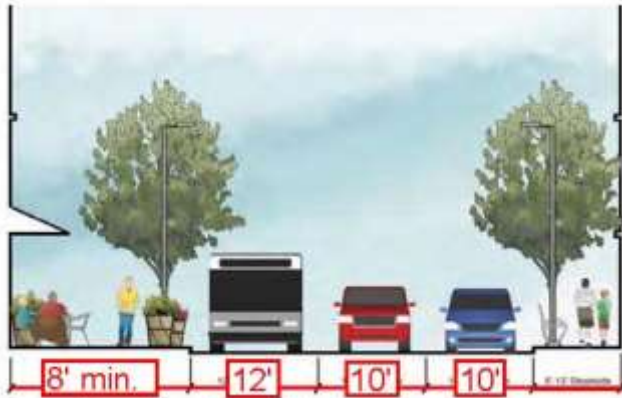

PROPOSED COMMERCE ST.





STAMPED CONCRETE PVM'T





CONCRETE PVM'T SECTION

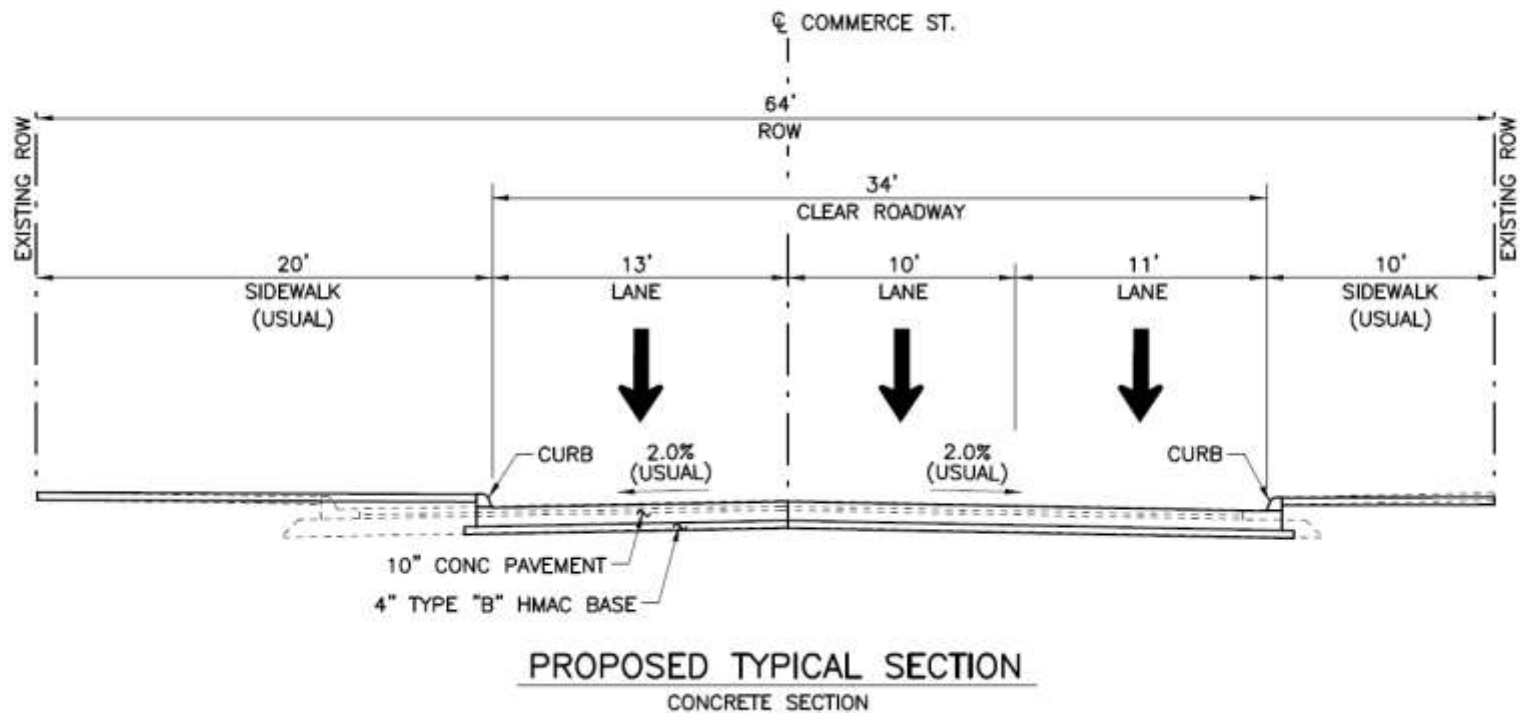



COMMERCE ST. - STREETScape

- Cultural District – La Zona Cultural
 - Gateway to Heart of La Zona Cultural
 - Express Culture & Heritage
 - Celebrate Artistry





SCHEMATIC DESIGN



2

CP&Y

Tdg

COMMERCE STREET SCHEMATIC DESIGN :: APRIL 2015



SCHEMATIC DESIGN





STREETSCAPE ELEMENTS



ACCENT WALL OPTION 1



ACCENT WALL OPTION 2

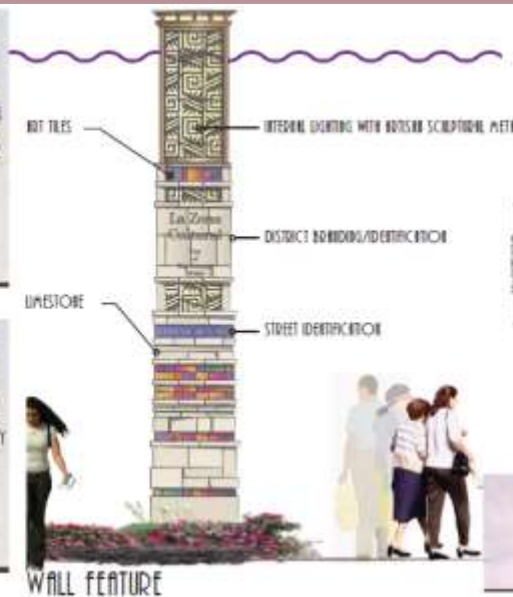

WALL FEATURE



WALL OPTION - SOUTH OF CITY HALL



ELEVATION: SEAT WALL FRONT
SEATING WALL



TRELLIS OVER BRIDGE



COMMERCE STREET SCHEMATIC DESIGN :: APRIL 2015



DESIGN ELEMENTS AND COST ESTIMATE

CONCRETE SIDEWALK PAVING



COST ESTIMATE

1. CONCRETE PAVING WITH SCORED JOINTS AND FINE BROOM FINISH. = \$ 7.56/SQFT.
2. CONCRETE PAVING WITH INTEGRAL COLOR, HANDSCORED JOINTS AND FINE FINISH. = \$ 9.56/SQFT.

CONCRETE WALK BANDING



COST ESTIMATE

1. 36" WIDE BANDING WITH STONE TO MATCH COLOR OF EXISTING PLAZA STONE. = \$ 14.00/SQFT.
2. 36" WIDE MOSAIC TILE BANDING BY ARTIST. = \$ 8.00/SQFT.
3. 36" WIDE CERAMIC TILE BANDING. = \$ 6.50/SQFT.

9



COMMERCE STREET DESIGN ELEMENTS :: APRIL 2015



DESIGN ELEMENTS AND COST ESTIMATE

BENCHES

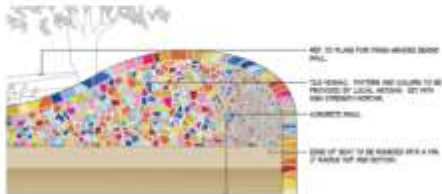

COST ESTIMATE

1. LIMESTONE SEATING BENCH 8' LONG. = \$ 1,075/ER.
2. LIMESTONE MASONRY WALL WITH SPACED JOINTS AND CERAMIC TILE INSERTS. FINISHED BOTH SIDES. = \$ 48/SQFT.
3. CERAMIC TILE SEATING BENCH. = \$ 300/UNIT.

PLANTERS



COST ESTIMATE

1. CONCRETE PLANTERS OF VARIOUS DIMENSIONS. = \$ 250 - \$ 750

10



COMMERCE STREET DESIGN ELEMENTS :: APRIL 2015



DESIGN ELEMENTS AND COST ESTIMATE

STREET AND WALK LIGHTING

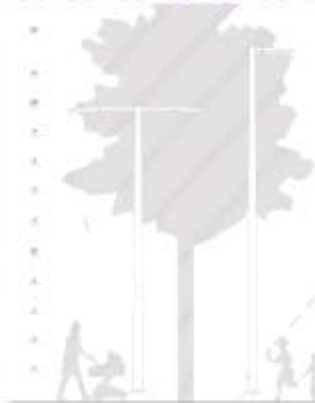

COST ESTIMATE

1. 25' HT. STREET LIGHT WITH LED CUT-OFF FIXTURE = \$ 6,500
2. 25' HT. STREET LIGHT WITH LED CUT-OFF FIXTURE AND PEDESTRIAN LED FIXTURE MOUNTED AT 14' HT.
3. 25' HT. STREET LIGHT WITH LED CUT-OFF FIXTURE AND THREE ARM LED FLOOD LIGHT MOUNTED AT 20' HT.

TREE AND ARCHITECTURAL LIGHTING



COST ESTIMATES

1. UP-LIGHTING BOLLARD WITH GLARE Baffles = \$ 1,300

11



COMMERCE STREET DESIGN ELEMENTS :: APRIL 2015



DESIGN ELEMENTS AND COST ESTIMATE

STRING LIGHTS



COST ESTIMATE

1. 3,000 LF. LED STRING LIGHTS = \$20/LF.

STREET TREES



TREES RECOMMENDED TO BE:
VASE SHAPED WITH ASCENDING BRANCHES
AND CONTAINER GROWN.

COST ESTIMATE

1. 200 GIL COUNT SHADE TREE = \$2,500
18"-20" HT.
2. 300 GIL COUNT SHADE TREE = \$3,200
20"-24" HT.
3. 100 GIL COUNT FLOWERING = \$900
ORNAMENTAL TREE

12



COMMERCE STREET DESIGN ELEMENTS :: APRIL 2015

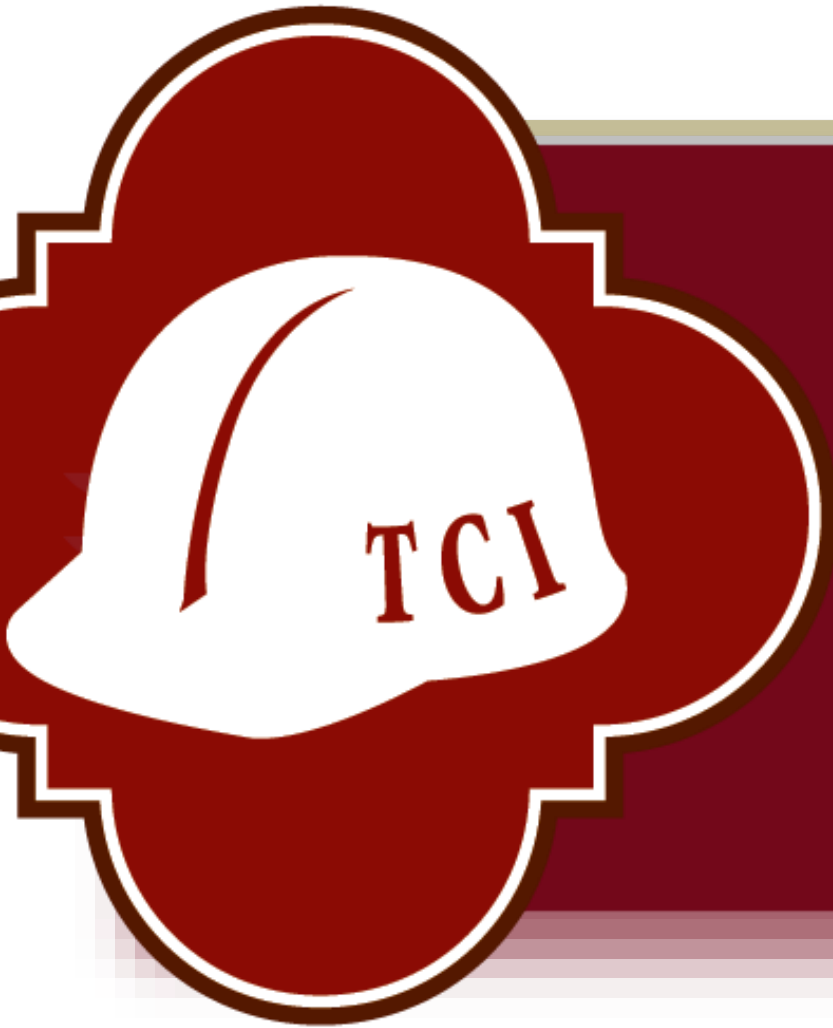

**COMMERCE STREET
DESIGN CONCEPTS**

MAY 14, 2015

***THANK YOU FOR YOUR
ATTENDANCE***